

Geberit Monolith sanitary module for bidet, 101 cm, with towel rail

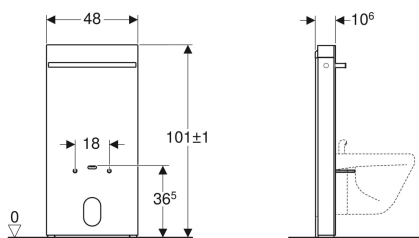

Example image



Application purposes

- For renovations, conversions and new buildings
- For floor-standing and wall-hung bidets
- For deck-mounted taps
- For wall inlets
- For water supply connections at the bottom
- For replacing wall-hung and floor-standing bidets
- For mounting on finished floors
- For installation in front of drywalls or solid walls

Characteristics

- Compensation of dimensional tolerances possible

Scope of delivery

- Water supply connection set with 2 elbow tap connectors 90° Rp 1/2" and G 3/8"
- P-trap
- Cover
- Base cover
- Fastening material for drywall
- Fastening material for solid wall

- Fastening distance for wall-hung bidet 18 cm
- Height-adjustable up to 7 cm
- Front cladding made of glass (ESG)
- Wall inlet height 8–21 cm from finished floor
- Fastening height wall-hung bidet 35 ± 1 cm
- Side cladding made of aluminium brushed
- Bright chrome-plated towel rail
- Self-supporting
- Water supply connection on the bottom

Technical data

Product material | Steel

Art. no.	Colour / surface	
131.030.SI.5	Front cladding: white glass Side cladding: aluminium	
131.030.JL.5	Front cladding: sand grey glass Side cladding: aluminium	New
131.030.JK.5	Front cladding: lava glass Side cladding: black chrome aluminium	New
131.030.SJ.6	Front cladding: black glass Side cladding: black chrome aluminium	New